

Installation of SPC Click Lock Flooring

Tools needed for the installation

Straight edge, Pencil, Chalk Line, Measuring tape, Power Crosscut Saw, Jigsaw for cutting irregular shapes, Rubber Mallet, Blue or Green Painter's Tape, Assorted spacers, the rubber hammer and EPE foam sheet of 1 mm.

Installation

Before installation, carefully inspect each plank for visual defects, damage and sheen under adequate lighting (daylight is the best)

The SPC is designed to be installed as a "floating" floor. Do not secure the planks to the subfloor. Use care when installing wall moldings and transition strips to not fasten through the product is a drop and lock product. Please see illustration below on proper install technique.

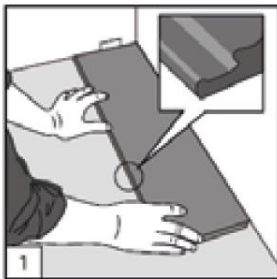

1. After check subflooring tolerance less than 3 mm. and dry, Must be installation of the EPE foam sheet with the thickness of 1 mm,

You can start the installation of the First plank, the first row. Place a spacer 8mm- 10mm thickness to the left and position the plank against the wall. Later, after 3 rows, you can easily position the flooring against the front wall with distances □ 8 mm – 10 mm.

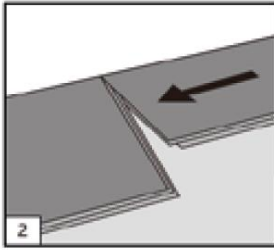

2. The Second plank, the first row- place this plank gently and tight to the short end of the first one.

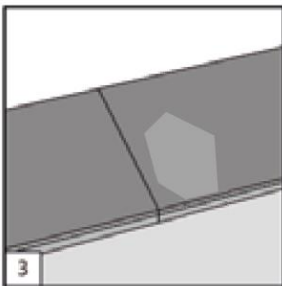

3. Fold the panel down in a single action movement. During the fold down, make sure the panels are tight against each other. Afterwards press down or slightly tap down at the short end just installed till it clicks. No major force is required.

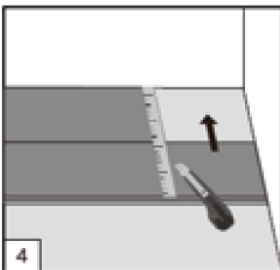

4. At the end of the first row, put a spacer 8mm-10mm to the wall and measure the length of the last plank to fit. The length of the cut SPC Floor should not be less than 30 cm.

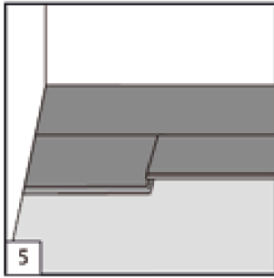

5. Starting the Second row the first plank should be a Half-length of piece (Or use the remaining plank from cutting the last plank of the first row to be the second row). Put a spacer against the wall and measure the last piece. If it is shorter than 30 cm. a new starter piece should be used. Insert the plank at an angle into the previous row and tap (on the long side) it in using a tapping block till flat.

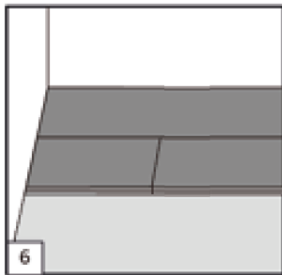

6. Fold the panel down in a single action movement with a slight press to the left to the short end of the previous panel. Again, using the tapping block tap it against the long end into the previous row. During the fold down, make sure the panels are tight against each other.

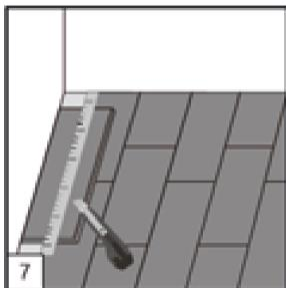

7. General distances between a long side ends. Minimum distance between a long side ends of the planks in parallel wall should not be less than 5 cm.

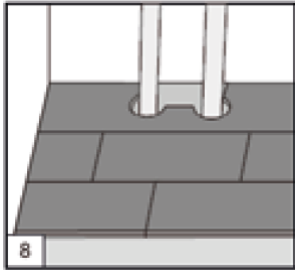

8. If there are any obstacles in the area which are higher than the installation areas, the SPC Floor with Click should be cut horizontally according to that obstacle. The additional space should be allowed for the expansion.

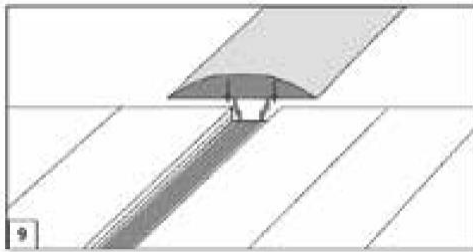

9. When installing of the products, please check the smoothness and the jointing between the planks. There should be no difference between each plank.

The gap of the partition where the skirt, the edging or the finishing parts are installed to close the gap for the expansion, should not be fastened by the glue or other materials which will be installed between the SPC floors in order to fix and stagnate the SPC floors.

For the installation of the SPC Flooring with Click in the wide area, if the width and the length of the area exceed the required area (The maximum width of the SPC Floors is 10x10m), the installation should be made in each zone and the space should be made between zones and should have the expansion joint parts.